

Archaeological Monitoring at No. 1 Jersey Road, Strood, Rochester, Kent

Site Code JERS/WB/13



Date of Report: 18/07/2013

Report for Sunil Purewal

SWAT ARCHAEOLOGY

Swale and Thames Archaeological Survey Company

The Office, School Farm Oast, Graveney Road

Faversham, Kent ME13 8UP

Tel; 01795 532548 or 07885 700 112

info@swatarchaeology.co.uk www.swatarchaeology.co.uk

Contents

1.0 SUMMARY.....	4
2.0 INTRODUCTION.....	4
2.1 PLANNING BACKGROUND.....	4
3.0 SCHEDULE OF VISITS.....	5
4.0 AIMS AND OBJECTIVES.....	5
4.1 PROPOSED GROUNDWORKS.....	5
4.2 CONFIDENCE RATING.....	5
5.0 ARCHAEOLOGICAL & GEOLOGICAL BACKGROUND.....	5
6.0 METHODOLOGY.....	6
7.0 RESULTS.....	6
7.1 GENERAL.....	6
8.0 FINDS.....	6
9.0 DISCUSSION.....	7
10.0 CONCLUSION.....	7
11.0 ACKNOWLEDGMENTS.....	7
REFERENCES.....	7
APPENDIX 1 - KCC HER Summary Form.....	8

Plate 1. Aerial Photograph of site (Google 2013)

Plate 2. General view of site

Plate 3. View of the site showing ground works

Plate 4. View of the site showing ground works for access

List of Figures

Figure 1. Site plan

Figure 2. Drawing of access car park bay

Figure 3. Drawing of proposed development

Archaeological Monitoring at No. 1 Jersey Road, Strood, Kent

Site Code JERS/WB/13



Plate 1. Aerial view of site (red circle) showing the site prior to development. (GoogleEarth 2013).

1.0 Summary

1.1. From 5th Feb to 11th July 2013 Swale and Thames Archaeological Survey Company (SWAT Archaeology) carried out an Archaeological Watching Brief on ground works involved in the development works at No. 1 Jersey Road, Strood, Kent (Fig. 1 & Plate 1).

1.2. The works were carried out on behalf of the owners and instructions received from Sunil Purewal of the same address.

1.3. An Archaeological Watch was kept during the machine excavation of the sequenced foundation trenches of the development and the excavation for a new vehicular car parking bay on to Castle View Road (Plates 3-4).

The archaeological work was undertaken in two phases.

Phase 1: Excavation of foundation trenches for new attached house

Phase 2: Excavation of new car parking bay

1.4. The Archaeological Watching Brief was to watch for any archaeological below ground impact.

1.5. The Planning Application Number for the development is: MC/09/1850.

1.6. Although the archaeological potential was medium the Archaeological Watching Brief revealed no buried archaeological features and no archaeological finds were retrieved.

2.0 Introduction

2.1 Planning Background

Planning application MC/09/1850 was submitted to the Local Planning Authority. Kent County Council Heritage and Conservation (KCCHC), on behalf of the Local Planning Authority (LPA) requested that an Archaeological Watching Brief be undertaken in order to record any archaeological remains uncovered during the development work. The following condition was attached to the planning consent:

No development shall take place until the developer has secured the implementation of a watching brief so that the under raking of ground works and excavation is observed and items of interest and finds are recorded. The watching brief shall be undertaken by a suitably qualified [archaeologist] and no work shall begin until the Local Planning Authority have confirmed in writing that the proposed archaeologist is suitable. The watching brief shall be undertaken in accordance with a written programme and specification which has first been submitted to and approved in writing by the Local Planning Authority prior to the commencement of development.

Reason: To safeguard the archaeological interest in the site in accordance with Policy BNE21 of the Medway Local Plan 2003.

3.0 Schedule of Visits

An archaeologist attended the site and monitored the excavation works from 5th Feb to 11th July 2013.

4.0 Aims and Objectives

4.1. The reason for the monitoring and recording, were to:

“Contribute to knowledge of the area through the recording of any archaeological remains exposed as a result of excavations in connection with the ground works. Particular attention will be paid to the character, height below ground level, condition, date and significance of the deposits.”

4.2. The ground works were to excavate the foundations of the new build attached four-bedroom house in sequential strips so not to compromise the stability of the adjoining building (Plate 3).

In addition a new car parking bay to be excavated adjacent to Castle View Road (Plate 4).

4.3. A full programme of proposed works by the contractor were made available to SWAT Archaeology before the on-site monitoring took place.

4.4. Confidence Rating

No factors hindered the recognition of archaeological and deposits during the monitoring and recording exercise.

5.0 Archaeological and Geological Background

5.1. The underlying geology at the site according to the British Geological Survey map is Upper Chalk of the Lewis Nodular Chalk Formation (BSG website 1: 50,000). The geology revealed on site was Chalk in the new build foundation trenches and a mix of dumped material in the excavation of the new car parking bay.

5.2. The application site consisted of an area of rear and side gardens situated on the western side of Jersey Road adjacent to the junction with Castle View Road. The site itself is generally level at a height of about 37m aOD.

5.3. The site lies within an area of known archaeological potential associated with archaeological remains presently recorded in the HER. The site lies just to the north of the line of Roman Watling Street. Evidence for Roman occupation has been found adjacent to this road with Roman burials (TQ 76 NW 54). In the late 19th century a Jutish grave was found within metres of the development site (TQ 76 NW 20) at the junction of Jersey and Castle View Roads.

6.0 Methodology

6.1. The Watching Brief was conducted in accordance with the Archaeological Specification compiled by KCC Heritage and it also complied with the Institute of Field Archaeologists' Standards and Guidance for Archaeological Watching Briefs (IfA: 1994, revised Oct 2008).

6.2. The works comprised the observation of all ground works, including the inspection of subsoil and natural deposits for archaeological features and finds.

6.3. The Watching Brief was carried out in two phases according to the needs of the building contractors from 5th Feb to 11th July 2013.

6.4. Excavation of the area of development was carried out by contractors using a 360 degree machine equipped with a toothed and toothless bucket (Plates 3, 4).

6.5. All excavation was carried out under the constant supervision of an experienced archaeologist.

6.6. Where necessary the areas of excavation would have been hand-cleaned with the intention of revealing any observed archaeological features in plan and section.

6.7. If found archaeological features under threat were to be excavated to enable sufficient information about form, development date and stratigraphic relationships to be recorded without prejudice to more extensive investigations, should these prove to be necessary.

6.8. The archaeological watching brief was carried out in accordance with current IfA Standards and Guidance, (IfA: 2008), and methodology itemised in the KCC specification.

7.0 Results

7.1 General

No archaeological features or finds were revealed or recovered. The subsoil encountered across the site was chalk overlaid by garden soil with no archaeological features revealed in the natural geology (Plate 3). In the construction of the car park bay excavation revealed numerous sequences of dumped material ranging from clay under re-deposited chalk overlaying clay and soil (Plate 4).

8.0 Finds

No buried archaeological features were located in the Archaeological Monitoring phase and no finds were retrieved.

9.0 Discussion

The development site is in an area of medium potential and the archaeological team were somewhat disappointed that no archaeology was revealed on the development site. The foundation trenches failed to reveal any archaeology and the excavation of the new car park bay revealed a sequence of dumped material deposited on truncated chalk.

10.0 Conclusion

The Archaeological Monitoring has fulfilled the primary aims and objectives of the Specification. As far as it is known no buried archaeological features have been affected as a result of the development.

11.0 Acknowledgments

SWAT Archaeology would like to thank Sunil Purewal for commissioning the project.

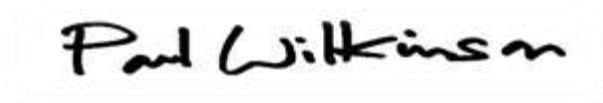
A handwritten signature in black ink that reads "Paul Wilkinson". The signature is written in a cursive, slightly slanted style. It is enclosed within a thin, light grey rectangular border.

Dr Paul Wilkinson, FRSA., MIfA.

References

HER data (KCC 2013)

IFA (1994 & 2008) Standards and Guidance for Archaeological Watching Briefs

KCC Archaeological Watching Brief (2013)

Appendix 1

Kent County Council HER Summary Form

Site Name: Development site at No. 1 Jersey Road, Strood, Kent

SWAT Site Code: JERS/WB/13

Site Address: As above

Summary:

Swale and Thames Survey Company (SWAT) carried out Archaeological Monitoring on the development site above. The site has planning permission for a new attached house whereby Kent County Council Heritage and Conservation (KCCHC) requested that Archaeological Monitoring be undertaken to determine the possible impact of the development on any archaeological remains.

The Archaeological Monitoring consisted of site visits which encountered no buried archaeological features or artefacts.

District/Unitary: Medway Council

Period(s):

NGR (centre of site to eight figures) 573106 169361

Type of Archaeological work: Archaeological Monitoring

Date of recording: April-July 2013

Unit undertaking recording: Swale and Thames Survey Company (SWAT. Archaeology)

Geology: Underlying geology is Chalk Formation.

Title and author of accompanying report: Wilkinson P. (2013) Archaeological Monitoring at
1. Jersey Road, Strood, Kent

Summary of fieldwork results (begin with earliest period first, add NGRs where appropriate)

See above

Location of archive/finds: SWAT. Archaeology. Graveney Rd, Faversham, Kent. ME13 8UP

Contact at Unit: Paul Wilkinson

Date: 18/07/2013

Plates



Plate 2. General view of site (facing west)



Plate 3. The site showing foundation excavation (facing east)



Plate 4. Excavation for access for car park bay to Castle View Road showing made-up ground (facing east)



1 Jersey Road, Strood ME2 3PB

Produced 17/07/2013 from the Ordnance Survey
National Geographic Database and incorporating
surveyed revision available at this date. © Crown
Copyright 2013

Reproduction in whole or in part is prohibited without
the prior permission of Ordnance Survey

Ordnance Survey and the OS Symbol are registered
trademarks of Ordnance Survey, the national mapping
agency of Great Britain.

The representation of a road, track or path is no
evidence of a right of way.

The representation of features as lines is no evidence
of a property boundary.

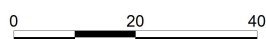

Scale 1:1250

Supplied By: National Map Centre Kent

Serial number: 001111655

Plot Centre Coordinates: 572985, 169366

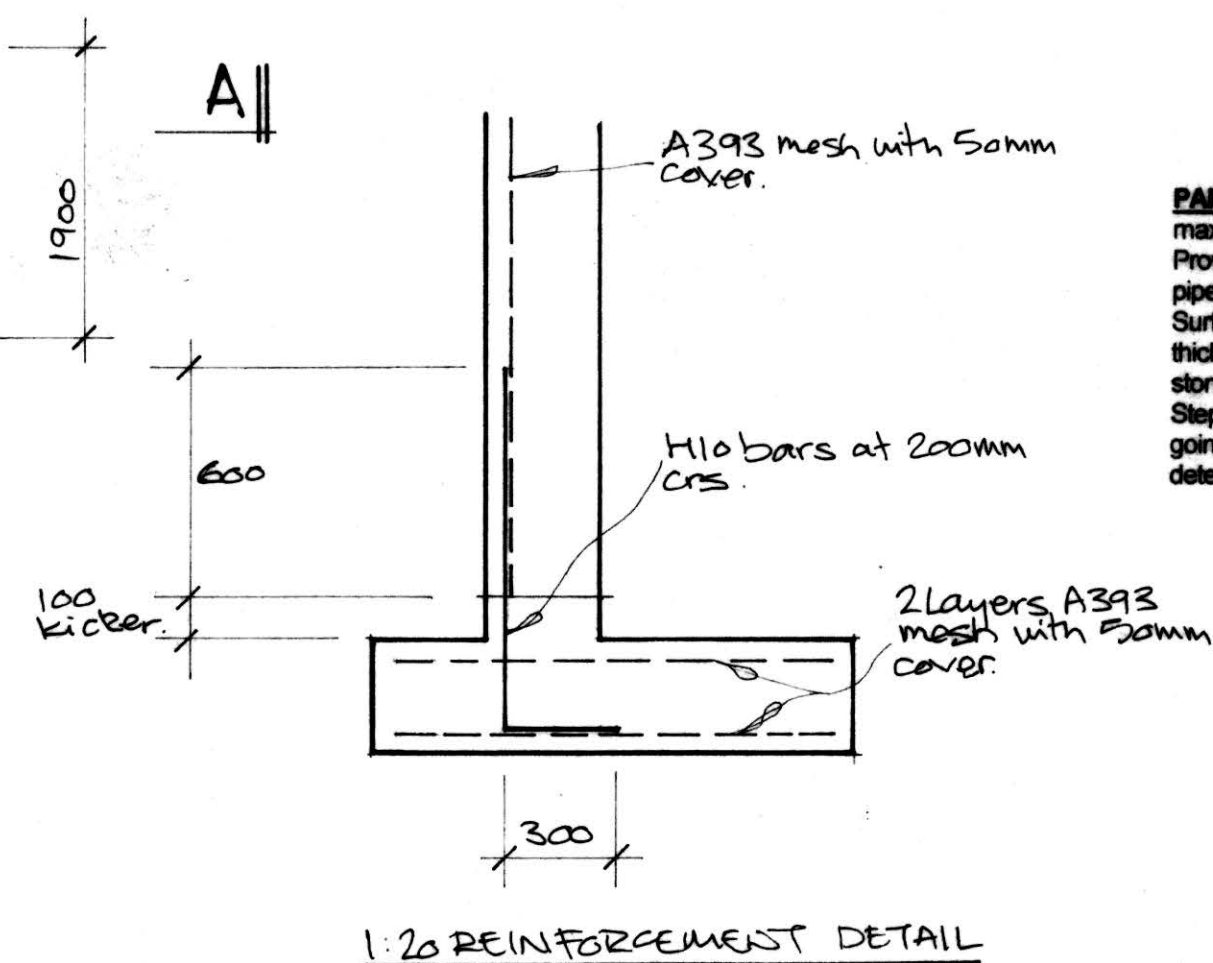
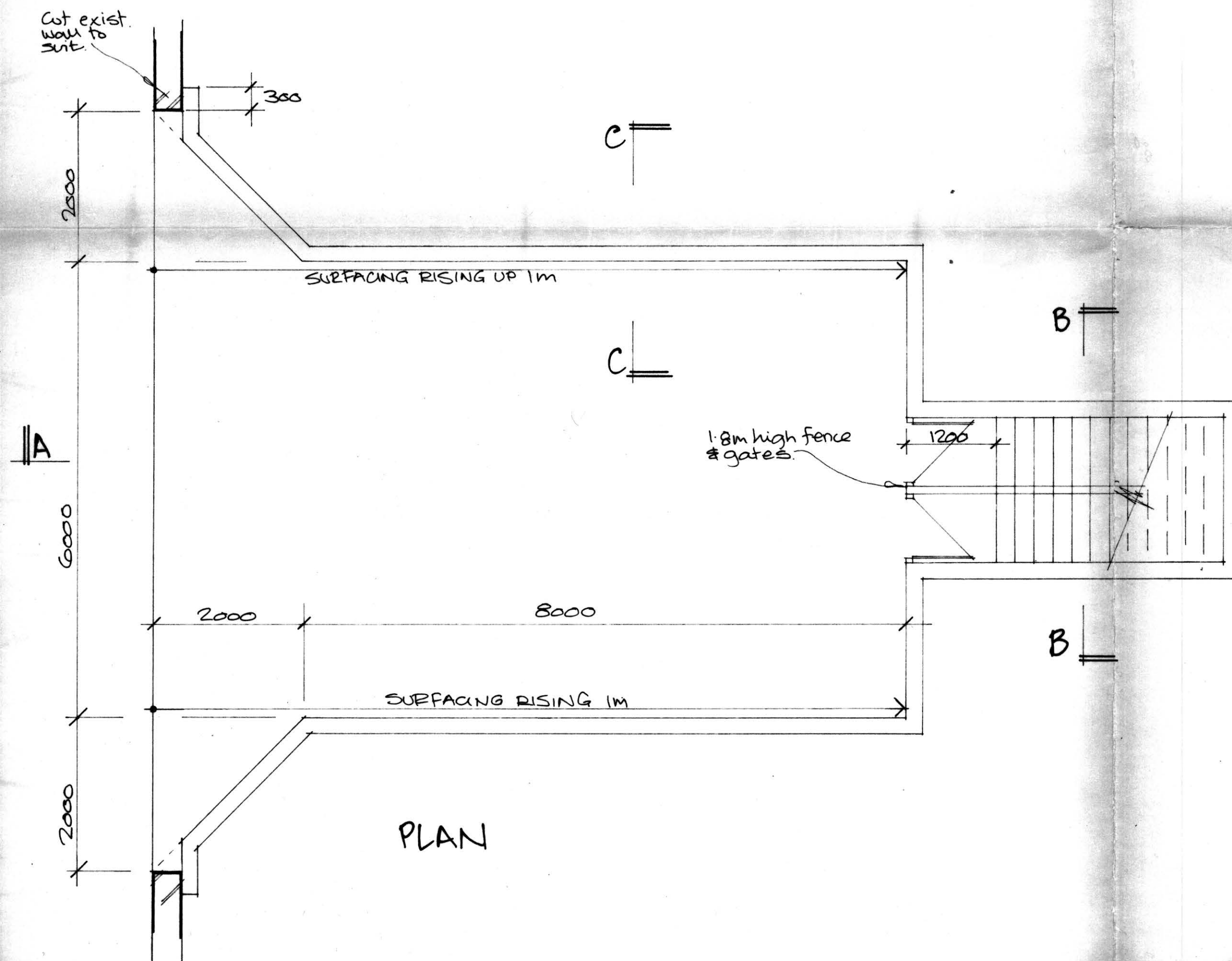
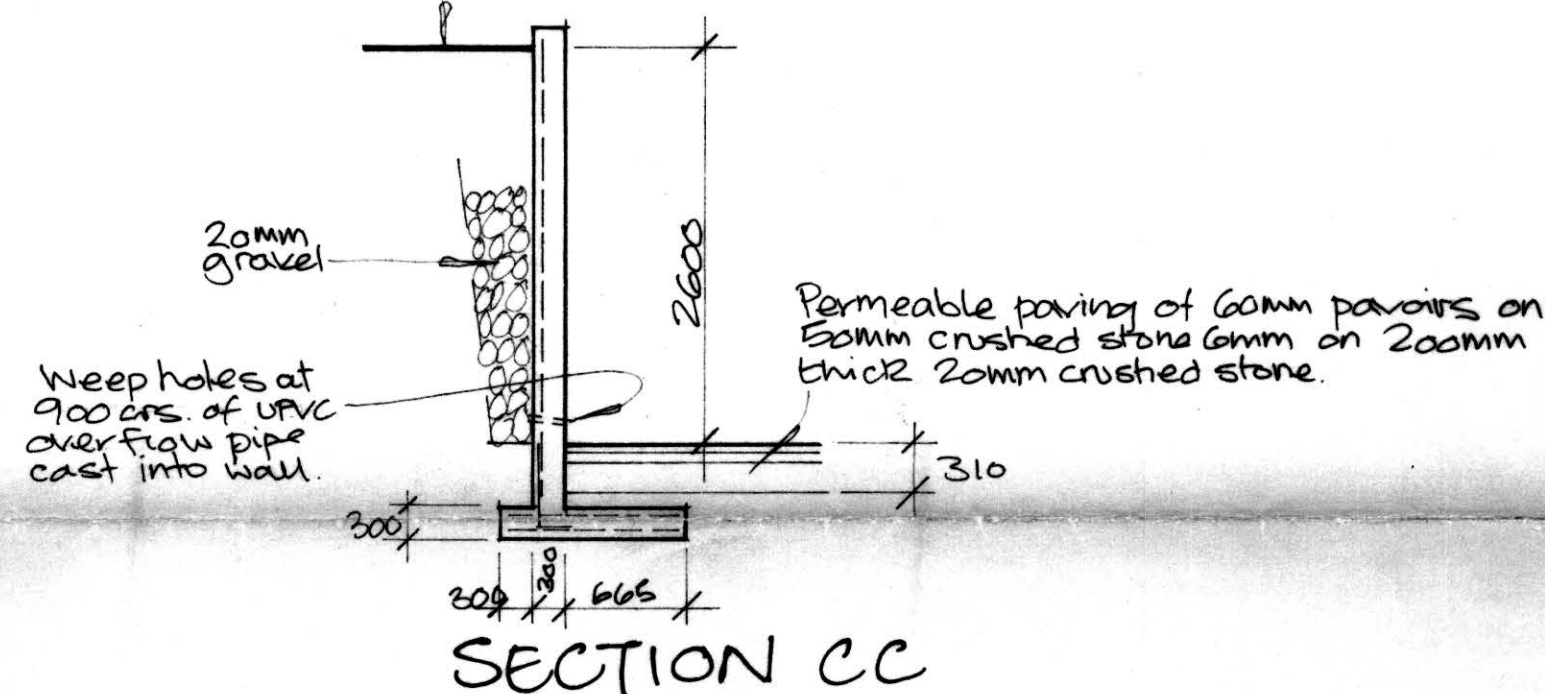
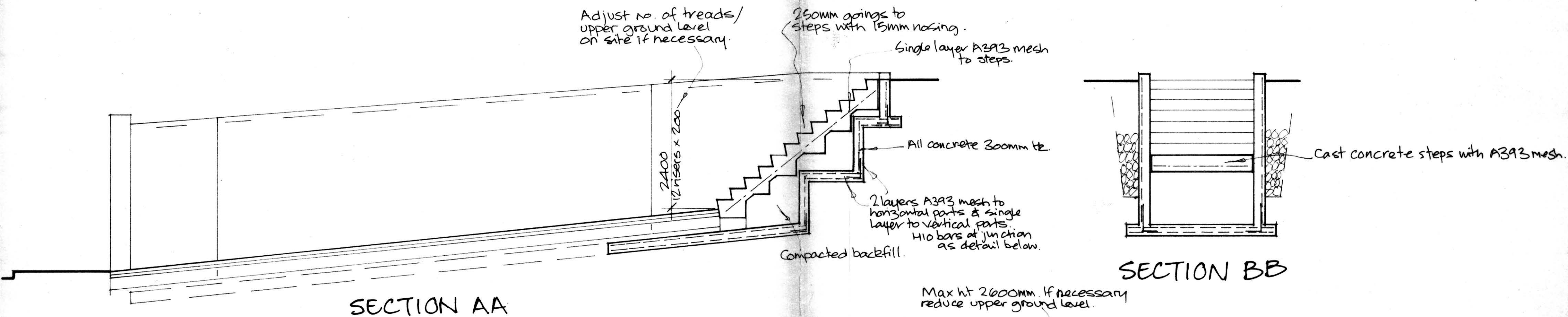

PARKING BAY: Reinforced concrete retaining walls (to max 2.6m high) to form parking area to engineers design. Provide weep holes at 900mm cns. using uPVC overflow pipe with 20mm gravel backfill behind walls. Surfacing of permeable design of block paving on 50mm thick 6mm crushed stone and 200mm thick 20mm crushed stone sub-base. Steps to be cast concrete of 200mm risers and 250mm goings and 15mm nosings. Final number of steps to be determined on site when levels are known.

**1 JERSEY ROAD,
STROOD,
KENT.**

PARKING BAY.

SEPTEMBER 2010
SCALE 1:50

